

RUBINETTO ACQUA

WATER BIB-COCKS

Rubinetto a sfera curvo

Angled ball cock

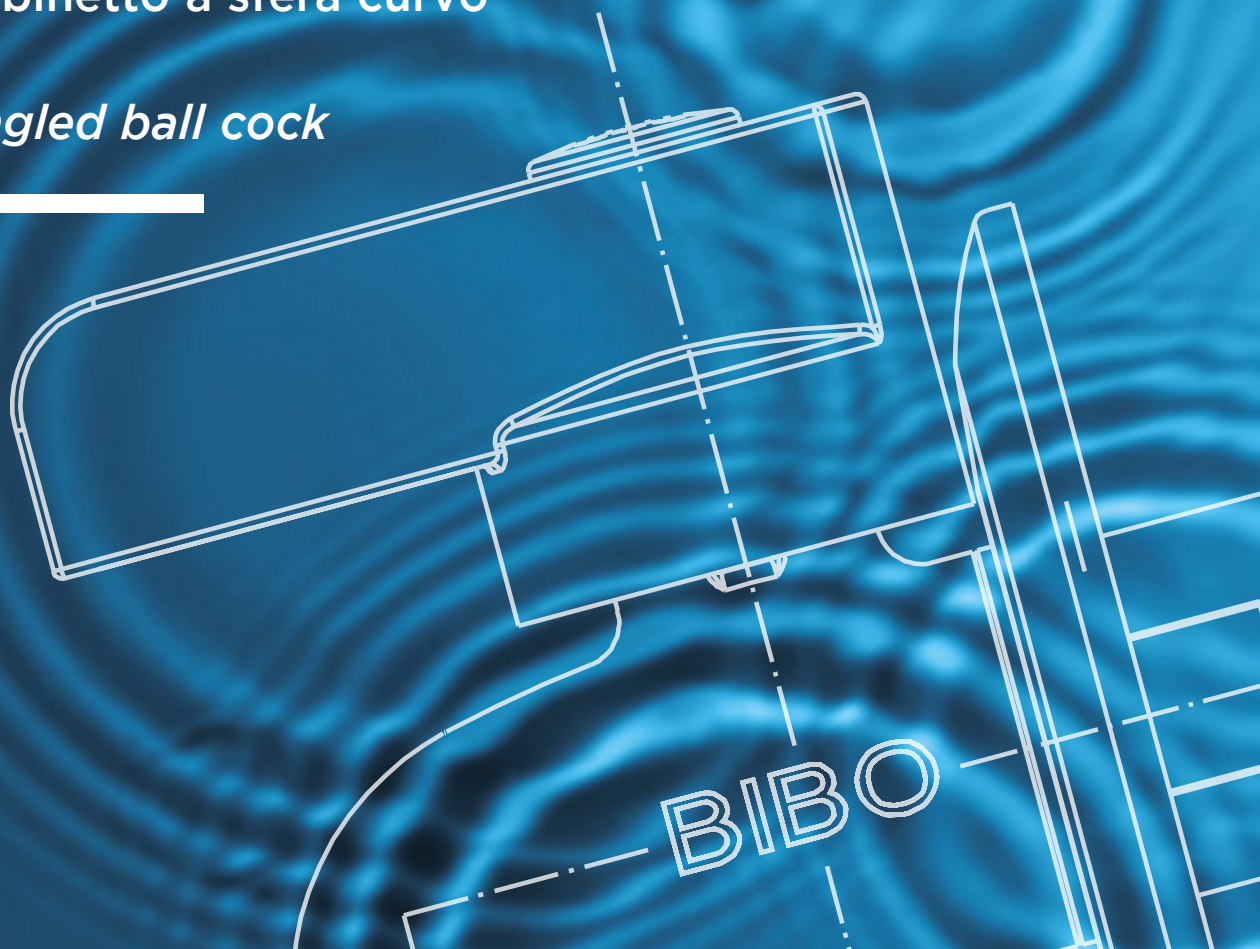



BIBO

RUBINETTO PER ATTACCO LAVATRICE
BIB-COCK WITH WASHING MACHINE CONNECTION

RUBINETTO SOTTOLAVABO
UNDERSINK BIB-COCK



APPROVATA EN 13828 / APPROVED TO EN 13828

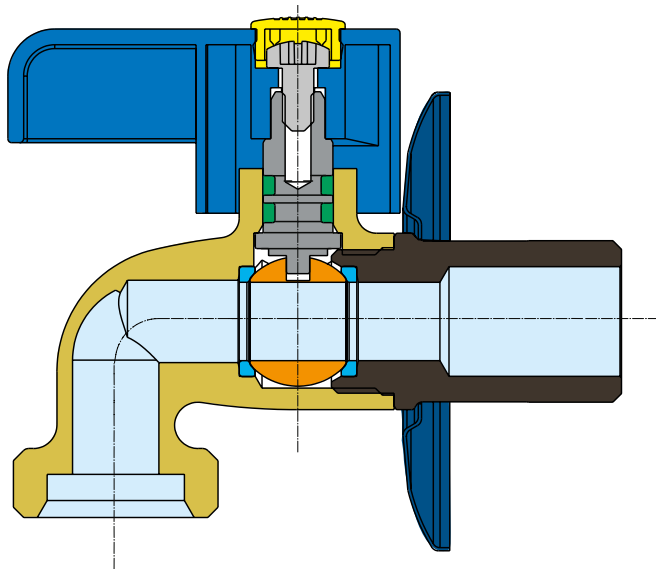

SPECIFICA MATERIALI / MATERIAL SPECIFICATION

PARTICOLARI / COMPONENT	MATERIALI / MATERIAL	DESCRIZIONE / DESCRIPTION
1 CORPO BODY	CW 617 N UNI EN 12165 CW 617 N UNI EN 12165	STAMPATO DA BARRA, NICHELATO FORGED, NICKEL-PLATED
2 MANICOTTO END ADAPTER	CW 617 N UNI EN 12165 CW 617 N UNI EN 12165	STAMPATO DA BARRA, NICHELATO FORGED, NICKEL-PLATED
3 SFERA BALL	CW 614 N UNI EN 12164 CW 614 N UNI EN 12164	DA BARRA, NICHEL-CROMATA MACHINED, CHROME-PLATED
4 SEDI LATERALI BALL GASKETS	P.T.F.E. P.T.F.E.	VERGINE PURE
5 PERNO STEM	CW 614 N UNI EN 12164 CW 614 N UNI EN 12164	DA BARRA MACHINED
6 O-RINGS O-RINGS	ELASTOMERO ELASTOMER	ADATTO ALL'USO PER ACQUA SUITABLE FOR USE WITH WATER
7 LEVA HANDLE	PLASTICA PLASTIC	PLASTIFICATA CROMATA PLASTIC CHROME-PLATED
8 VITE SCREW	ACCIAIO 8G 8G STEEL	ZINCATA ZINC-PLATED
9 ROSONE LOCK SHIELD	ACCIAIO INOX STAINLESS STEEL	CROMATO CHROME-PLATED
10 TAPPO PLUG	PLASTICA PLASTIC	STAMPATO MOLDED

CARATTERISTICHE

Progetto accurato, di solida costruzione per una lunga durata. Tenuta perfetta alle varie condizioni di esercizio.

FILETTATURE

Estremità filettate ISO 228/1

IMPIEGHI

Acqua fredda e calda, aria compressa, olii, fluidi non corrosivi, benzine. Per impieghi particolari vedere la tabella delle resistenze chimiche.

PRESSIONE DI ESERCIZIO

Max PN16.

Vedere diagramma pressione/temperatura.

LIMITI DI TEMPERATURA

Da -20°C a +90°C.

Vedere diagramma pressione/temperatura.

NOTE

In accordo alla UNI EN 13828 in presenza di acque aggressive per la lega di ottone, in ottemperanza alla UNI EN ISO 6509, è necessario l'utilizzo della lega di ottone antidezincificante. La produzione è disponibile su richiesta.

FEATURES

Accurate design, solid structure for a long-lasting product. Perfectly tight under all working conditions.

END CONNECTIONS

Ends are ISO 228/1 threaded.

USES

Hot and cold water, compressed air, oils, non corrosive fluids, fuels.

For any special uses see the table of chemical resistance.

WORKING PRESSURE

PN 16 max.

See pressure/temperature diagram.

TEMPERATURE LIMITS

From -20°C to + 90°C.

See pressure/temperature diagram.

NOTE

According to UNI EN 13828 in presence of water which could be aggressive for brass alloy, as agree with UNI EN ISO 6509 standard, is necessary the DZR brass alloy. The manufacture is available on request.



Diagramma pressione/temperatura

(prova eseguita con acqua)

Pressure/temperature diagram

(tested carried with water)

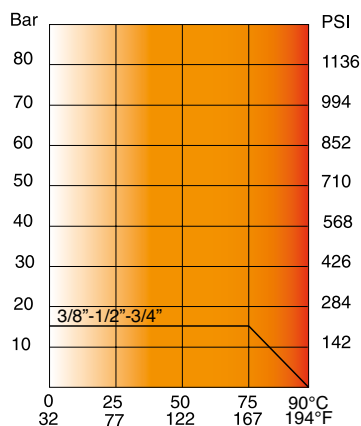

Diagramma perdite di carico

Loss of head diagram

BIBO

Rubinetto a sfera curvo
Angled ball cock

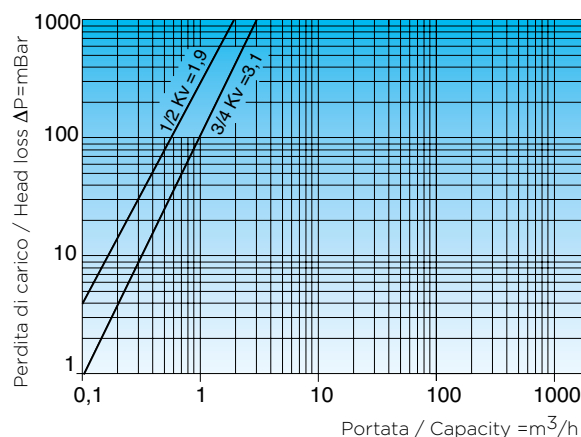
Art. S.0121 BIBO•PLUS

ERC



SIZE	1/2"								
øA pass./bore	10								
B mm	37,5								
C mm	25,5								
D mm	10,2								
E mm	41								
F mm	64,5								
G mm	50								
H mm	58								
SW mm	18								

Rubinetto a sfera curvo, attacco per portagomma con levetta e rosone, con chiave di avvitamento a muro, cromato lucido, per uso interno.

Angled ball bib cock, with coupling for hose connector, with lever and lock shield, with a spanner for screwing it to the wall, polished chrome-plated, internal use.

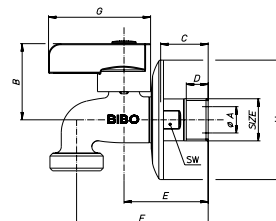

Art. S.0031 BIBO•LUX

ERC



SIZE	3/8"	1/2"							
øA pass./bore	10	10							
B mm	37,5	37,5							
C mm	14,6	14,6							
D mm	33	33							
E mm	56	56							
F mm	50	50							

Rubinetto a sfera curvo, attacco per portagomma con levetta e rosone, cromato lucido, per uso interno.

Angled ball bib cock, with coupling for hose connector, with lever and lock shield, polished chrome-plated, internal use.

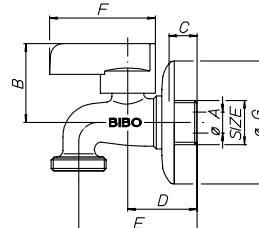

Art. S.0032 BIBO

ERC



SIZE	3/8"	1/2"							
øA pass./bore	10	10							
B mm	37,5	37,5							
C mm	15	15							
D mm	33	33							
E mm	71	71							
øF mm	16	16							
G mm	50	50							

Rubinetto a sfera curvo, con portagomma, con levetta bianca, nichelato.

Angled ball bib cock, with hose connector, with white lever, nickel-plated.

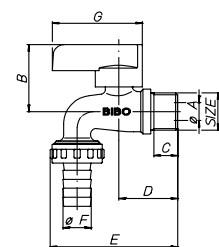

Art. S.0033 BIBO•LUX

ERC



SIZE	3/8"	1/2"							
øA pass./bore	10	10							
B mm	37,5	37,5							
C mm	14,6	14,6							
D mm	33	33							
E mm	71	71							
øF mm	16	16							
G mm	50	50							
øH mm	58	58							

Rubinetto a sfera curvo, con portagomma con levetta e rosone, cromato lucido, per uso interno.

Angled ball bib cock, with hose connector, with lever and lock shield, polished chrome-plated, internal use.

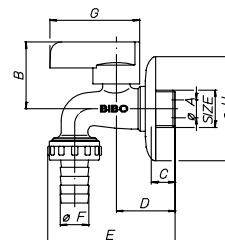

Art. S.0034C BIBO•LUX

EAC



SIZE	3/8"	1/2"							
øA pass./bore	10	10							
B mm	65	65							
C mm	80	80							
D mm	50	50							
E mm	14,6	14,6							

Rubinetto a sfera curvo per botti, con bocchello, con levetta, cromato lucido, per uso interno.

Angled ball bib cock for wooden casks, and nozzle, with lever, polished chrome-plated, internal use.

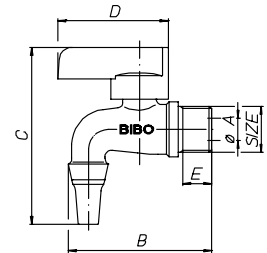

Art. S.0034N BIBO

EAC



SIZE	3/8"	1/2"							
øA pass./bore	10	10							
B mm	65	65							
C mm	80	80							
D mm	50	50							
E mm	14,6	14,6							

Rubinetto a sfera curvo per botti, con bocchello, con levetta bianca, nichelato.

Angled ball bib cock for wooden casks, and nozzle, with white lever, nickel-plated.

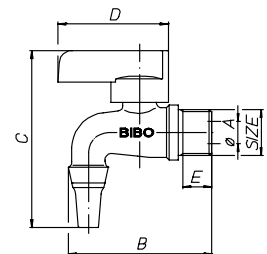

Art. S.0035 BIBO•LUX

EAC



SIZE	3/8"	1/2"							
øA pass./bore	10	10							
B mm	65	65							
C mm	80	80							
D mm	50	50							
E mm	14,6	14,6							

Rubinetto a sfera curvo per botti, con bocchello completo, con levetta, cromato lucido, per uso interno.

Angled ball bib cock for wooden casks, with complete nozzle, with lever, polished chrome-plated, internal use.

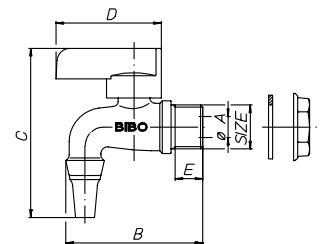

Art. S.0039 BOLA

EAC



SIZE	1/2" x 1/2"								
A mm	68,7								
B mm	30								
C mm	17								
øD mm	1/2"								
øE mm	1/2"								
F mm	39								
G mm	31,2								
øH pass./bore	10								
I mm	12								

Rubinetto a sfera a squadra femmina/maschio con levetta cromata, nichelato.

Angled ball bib cock, female/male with chrome-plated lever, nickel-plated.

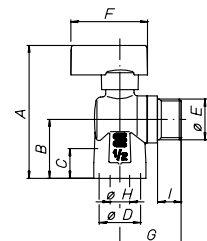

BIBO

Rubinetto a sfera curvo
Angled ball cock

Art. S.0041 BOLA

ERAC



SIZE	1/2"x1/2"	3/4"x1/2"				
A mm	70,8	71,1				
B mm	32	32,3				
C mm	15	12,5				
øD mm	1/2"	3/4"				
øE mm	1/2"	1/2"				
F mm	39	39				
G mm	31,2	31,2				
øH pass./bore	10	10				

Rubinetto a sfera a squadra maschio/maschio con levetta cromata, nichelato.

Angled ball bib cock, male/male with chrome-plated lever, nickel-plated.

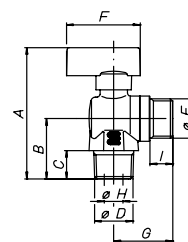

Art. S.0045

RUBINETTO PER LAVATRICI
BALL COCK FOR
WASHING MACHINES

ERAC



SIZE	1/2"x1/2"					
A mm	47					
B mm	30					
øC mm	14,2					
øD	1/2"					
øE	1/2"					
øF mm	16,3					
G mm	15					

Rubinetto a sfera per lavatrice in ottone cromato, completo di rosone.

Ball bib cock for washing machines in chrome-plated brass, equipped with lock shield.

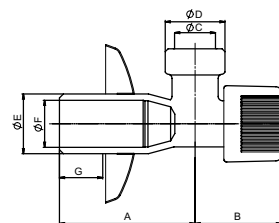

Art. S.0045

RUBINETTO PER LAVATRICI
BALL COCK FOR
WASHING MACHINES

ERAC



SIZE	1/2"x3/4"					
A mm	52					
B mm	27					
øC mm	25					
øD	1/2"					
øE	57					
øF mm	22					
G mm	15,6					
øH	9					
øI	3/4"					
SW mm	19					

Rubinetto a sfera per lavatrice in ottone cromato, completo di rosone.

Ball bib cock for washing machines in chrome-plated brass, equipped with lock shield.

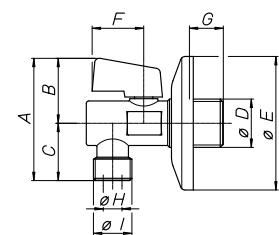

Art. S.0125

RUBINETTO SOTTOLAVABO
(SENZA SNODO SFERICO)
UNDERSINK BALL COCK
(WITHOUT BALL JOINT)

ERAC



SIZE	1/2"					
A mm	52					
B mm	27,5					
C mm	24,5					
øD	1/2"					
E mm	15					
F mm	22					
øG pass./bore	14					
øH	1/2"					
I mm	47					
L mm	60					
øM mm	55					

Rubinetto a sfera sottolavabo, cromato, senza snodo sferico.

Undersink bib-cock, chrome plated, without ball joint.

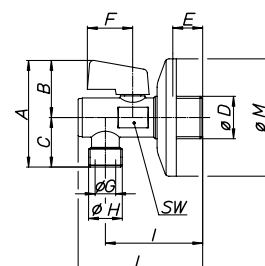

Art. S.0126

RUBINETTO SOTTOLAVABO
(CON SNODO SFERICO)

ERAC

UNDERSINK BALL COCK
(WITH BALL JOINT)



SIZE	1/2"x10mm						
A mm	88						
B mm	27,5						
C mm	60,5						
øD	1/2"						
øE mm	55						
F mm	22						
G mm	14,2						
øH pass./bore	10,2						
I mm	47						
L mm	60						
SW mm	19						

Rubinetto a sfera sottolavabo, cromo, con snodo sferico.

Undersink bib-cock, chrome plated, with ball joint.

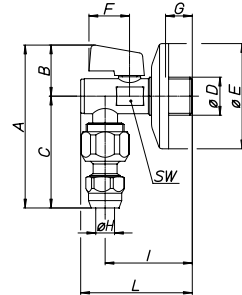

ART. S.0127

SOLO SNODO SFERICO
(COMPLETO DI GUARNIZIONE)

ERAC

BALL JOINT WITH GASKET
(WITH BALL JOINT)



SIZE	1/2"x10mm						
A mm	43,5						
øB pass./bore	10						
øC	1/2"						
SW mm	24						

Snodo sferico completo di guarnizione.

Ball joint with gasket.

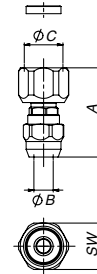

ART. S.0128

ERAC



SIZE	1/2"x10mm						
A mm	88						
B mm	27,5						
C mm	60,5						
øD	1/2"						
øE	55						
F mm	22						
G mm	15						
øH	10,2						
I mm	47						
L mm	70						
SW mm	19						

Rubinetto a sfera sottolavabo, cromo, con snodo sferico, versione lunga.

Undersink bib-cock, chrome plated, with ball joint, long version.

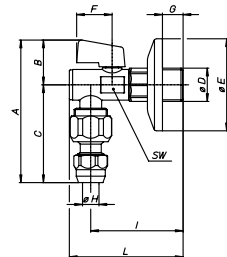

ART. S.0048 COMBI

ERAC



SIZE	1/2" x 3/4"						
øA mm	10						
B mm	116						
C mm	105						
D mm	87						
øE	56						
øF mm	15						
øG pass./bore	1/2"						

Rubinetto combinato sottolavabo attacco lavatrice.

Undersink combined tap with washing machine connection.

